

**EINBAU INDUKTIONSKOCHFELD SCHALTERBLENDEN**  
BUILT-IN INDUCTION STOVE SWITCH PANELS

**4** **KOCHSTELLEN (BI4EG...)**  
COOKING ZONES (BI4EG...)

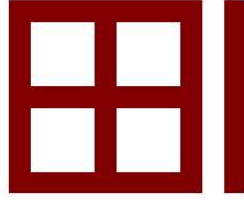

**BI4EG Standard**

BI4EG + AIS1

BI4EG + AIS4

BI4EG + Touch /OLED

BI4EG + Spin Control

Einbautiefe:  
/ Installation depth:

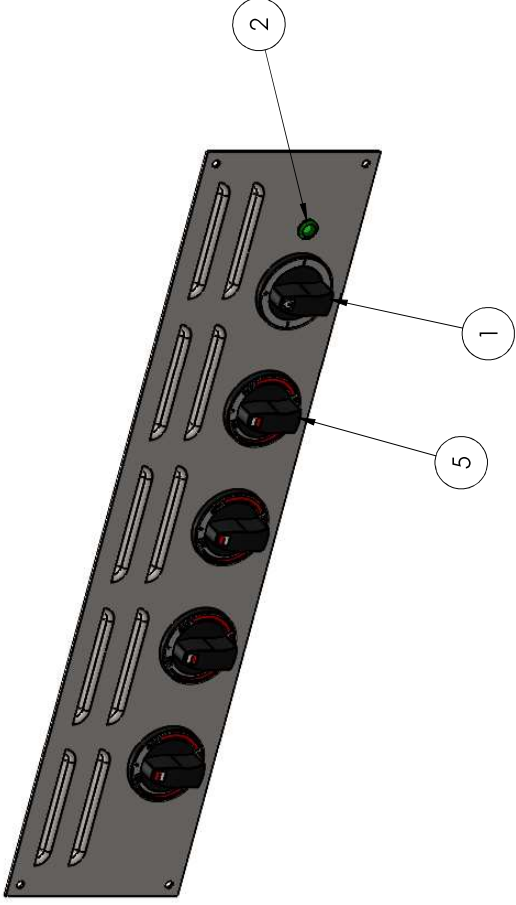
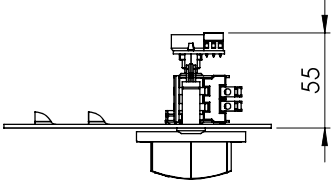

Stückliste siehe Seite 8 und 9 /  
For bill of materials see page 8 and 9

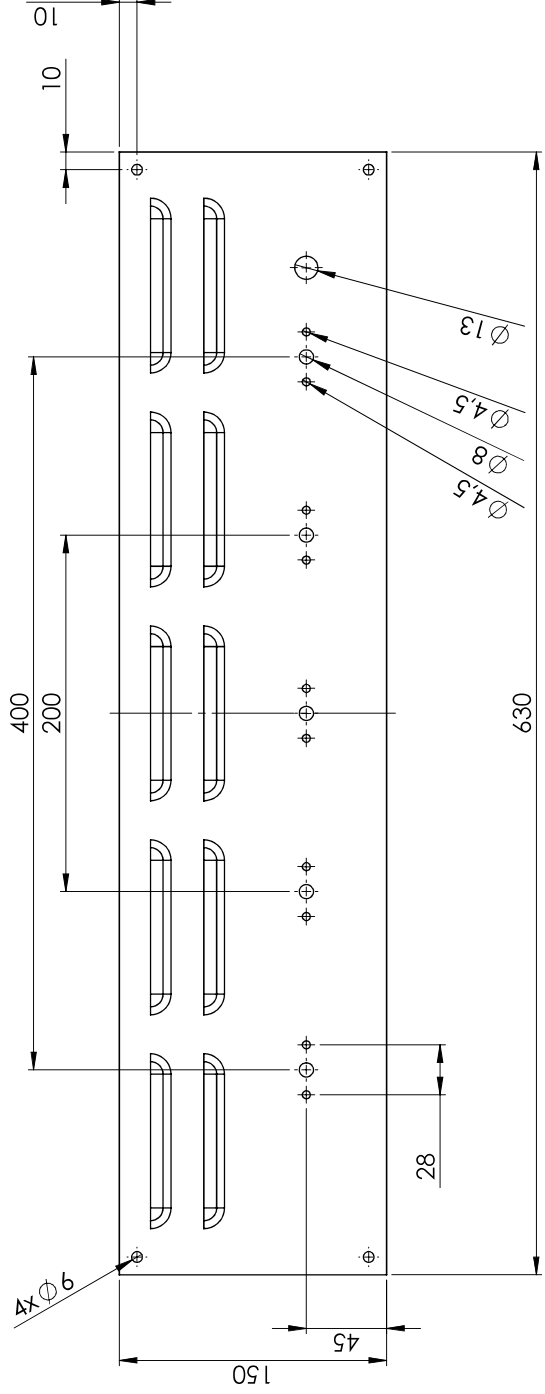

Artikelnummer / Item Nr. : 011.31012

BI4EG Standard

**BI4EG + AIS1**

BI4EG + AIS4

BI4EG + Touch /OLED

BI4EG + Spin Control

Einbautiefe:  
/ Installation depth:

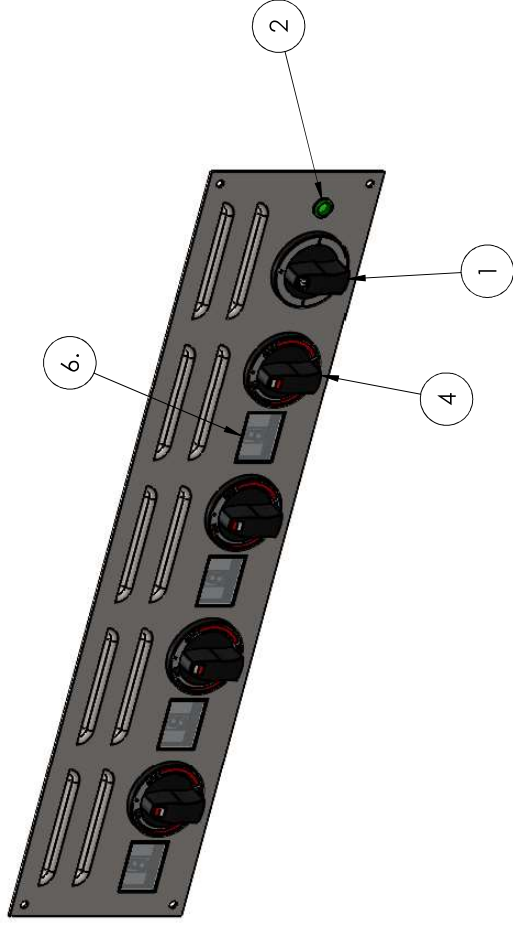

Stückliste siehe Seite 8 und 9 /  
For bill of materials see page 8 and 9

4x Ausschnitt 43 x 33 mm /  
4x cut out 43 x 33 mm

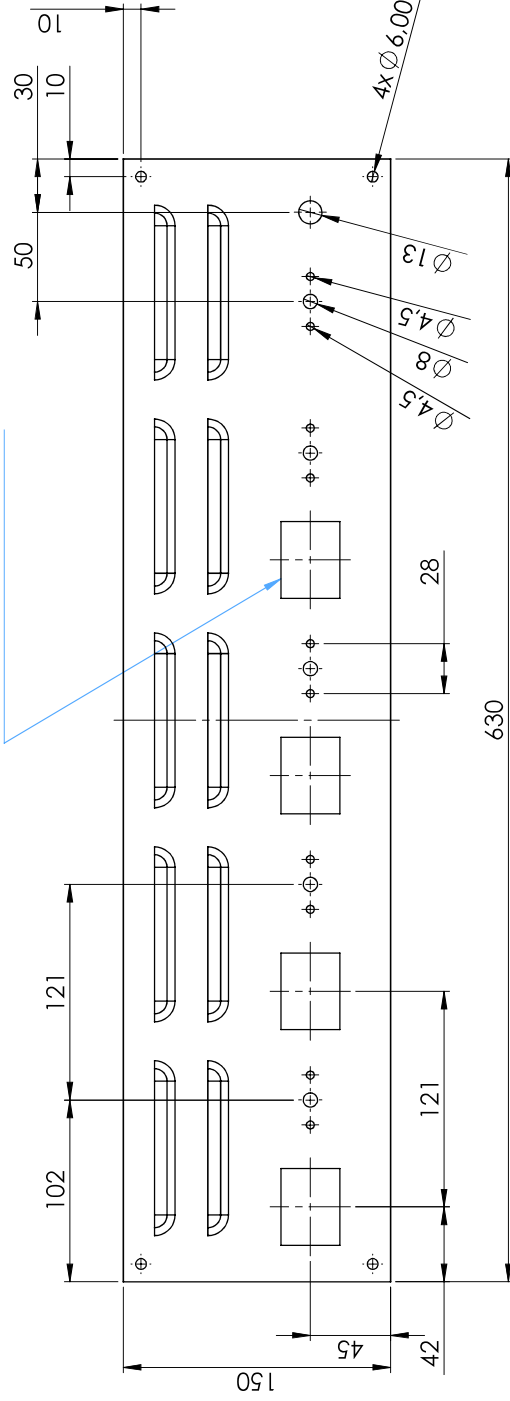

Artikelnummer / Item Nr. : 01 1.310xx

- BI4EG Standard
- BI4EG + AIS1
- BI4EG + AIS4**
- BI4EG + Touch /OLED
- BI4EG + Spin Control

Einbautiefe:  
/ Installation depth:

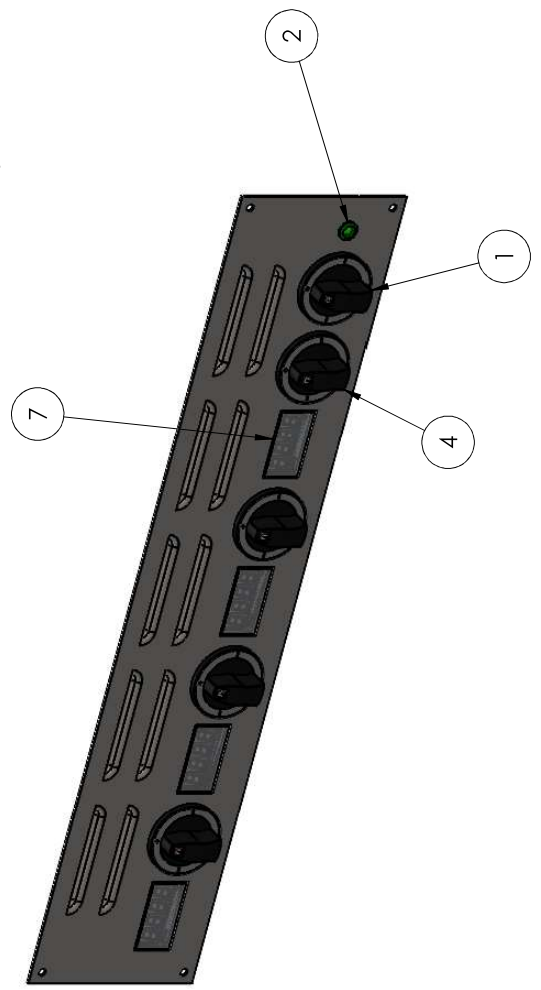
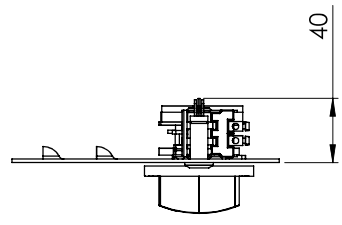

Stückliste siehe Seite 8 und 9 /  
For bill of materials see page 8 and 9

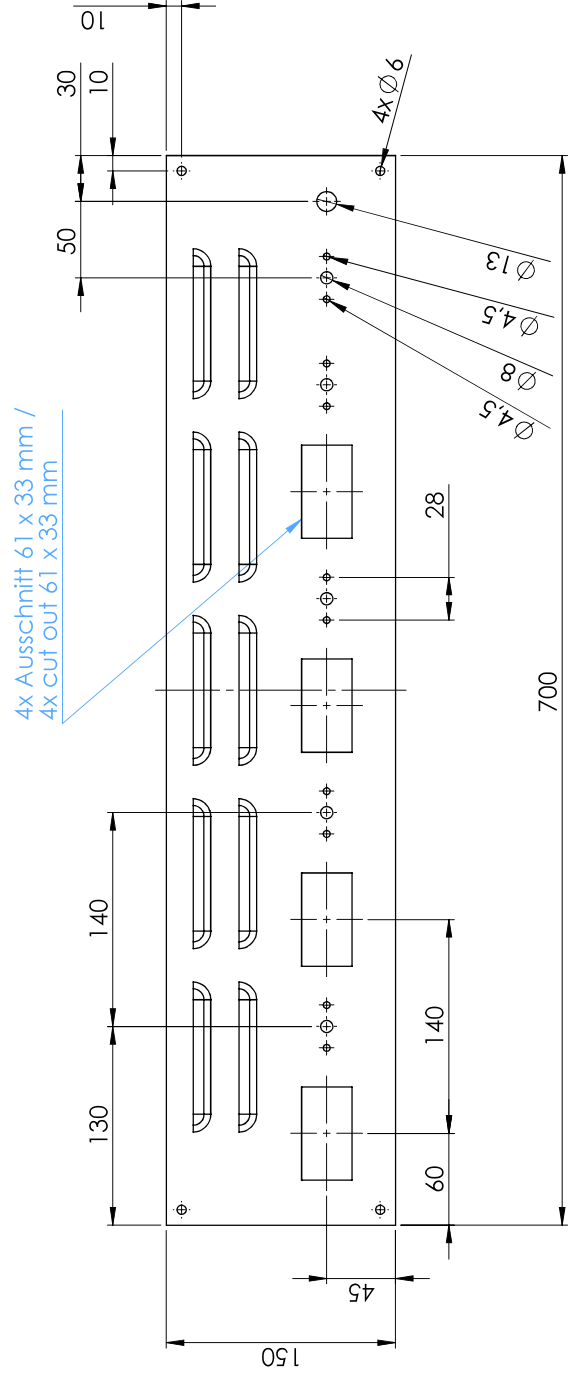

Artikelnummer / Item Nr. : 011.31028

- BI4EG Standard
- BI4EG + AIS1
- BI4EG + AIS4
- BI4EG + Touch / OLED**
- BI4EG + Spin Control

Einbautiefe:  
/ Installation depth:

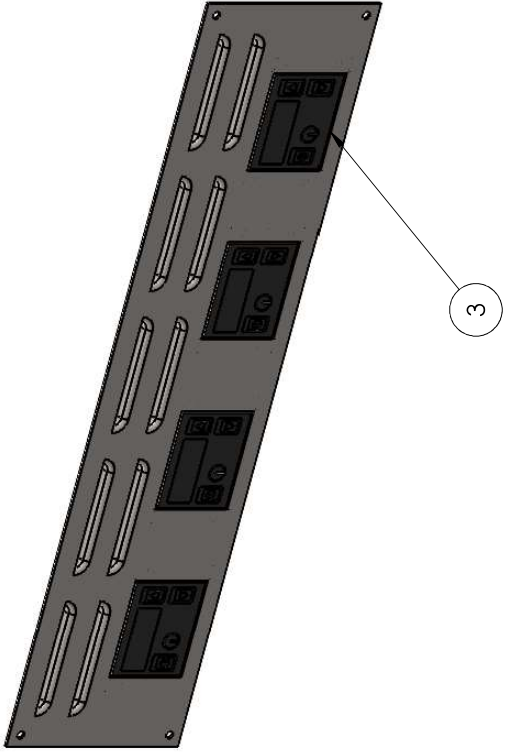
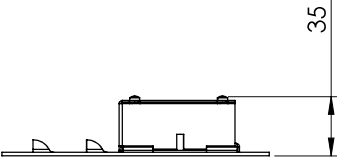

Stückliste siehe Seite 8 /  
For bill of materials see page 8

4x Ausschnitt 83 x 63 mm  
4x cut out 83 x 63 mm

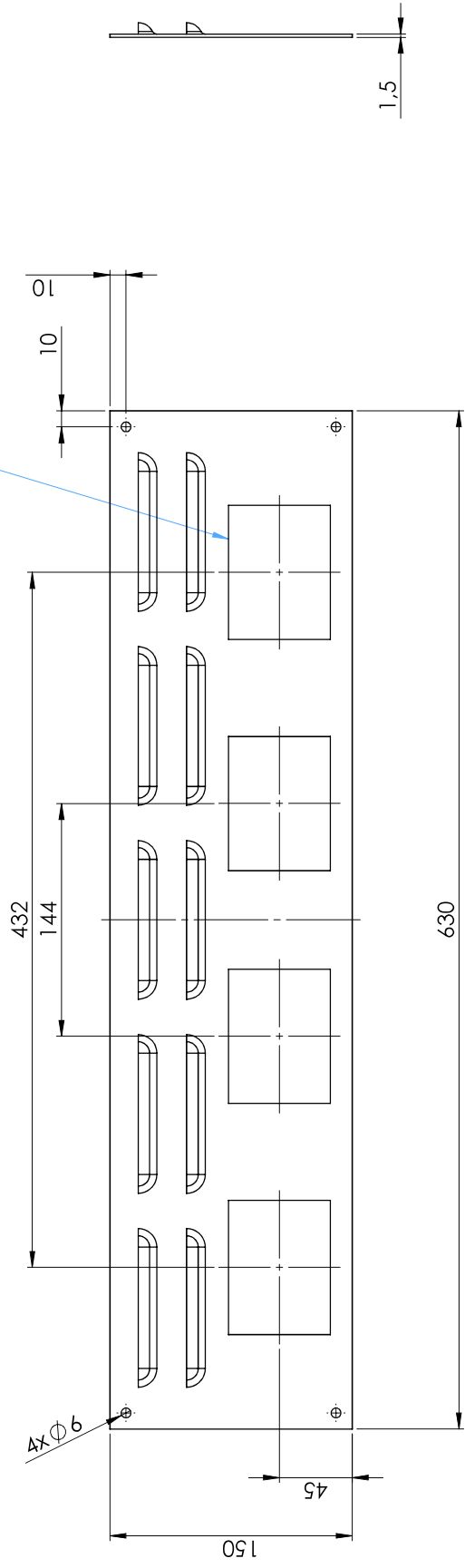

Artikelnummer / Item Nr. : 011.31013

- BI4EG Standard
- BI4EG + AIS1
- BI4EG + AIS4
- BI4EG + Touch /OLED
- BI4EG + Spin Control**

Einbautiefe:  
/ Installation depth:

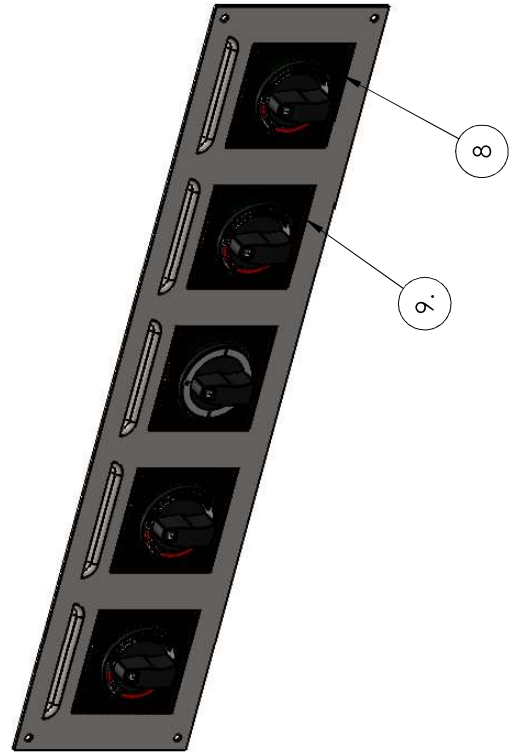
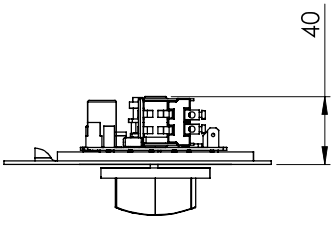

Stückliste siehe Seite 9 /  
For bill of materials see page 9

5x Ausschnitt 88 x 88 mm  
5x cut out 88 x 88 mm

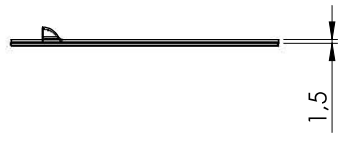
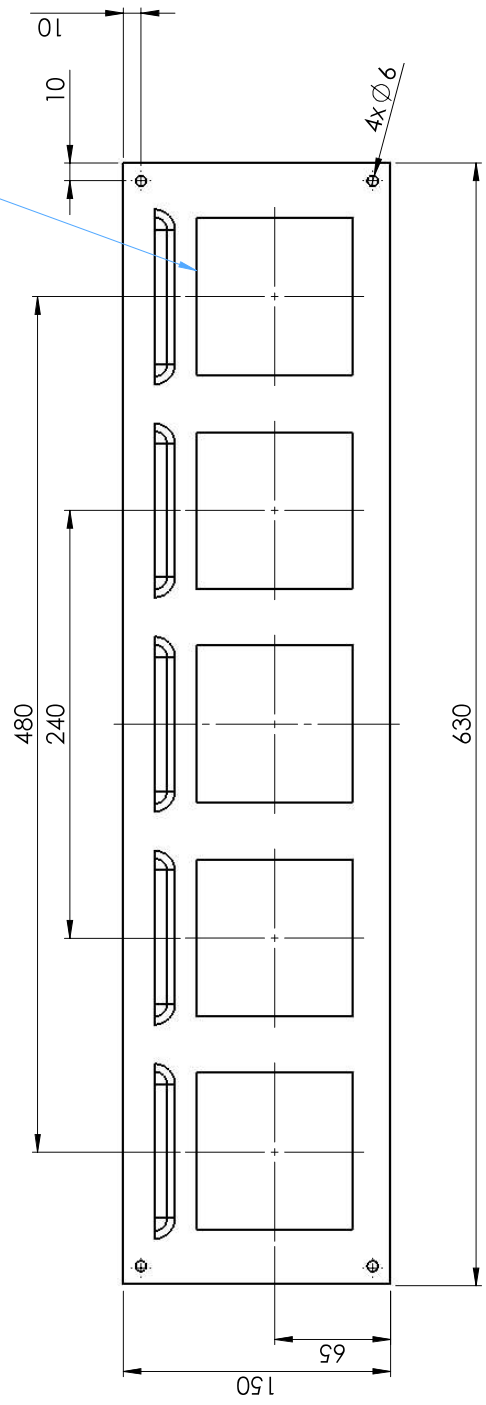

Artikelnummer / Item Nr. : 01 1.310xx

**BOLZENPOSITION**  
POSITION OF THE BOLTS

OLED

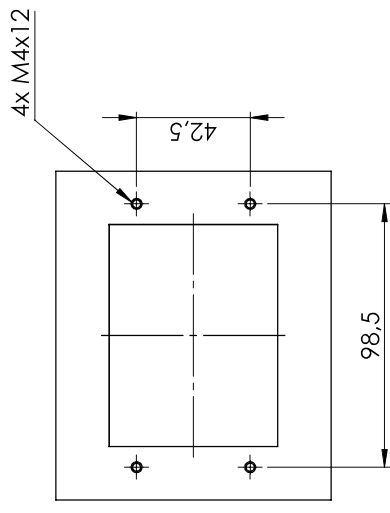
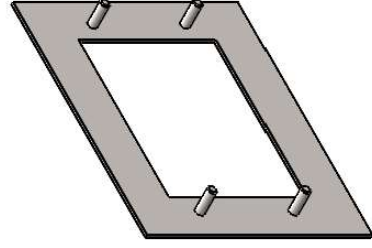

AIS1

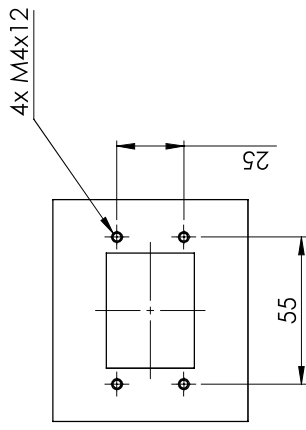
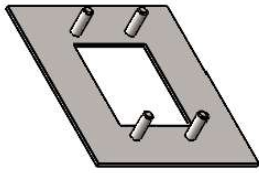

Spin Control

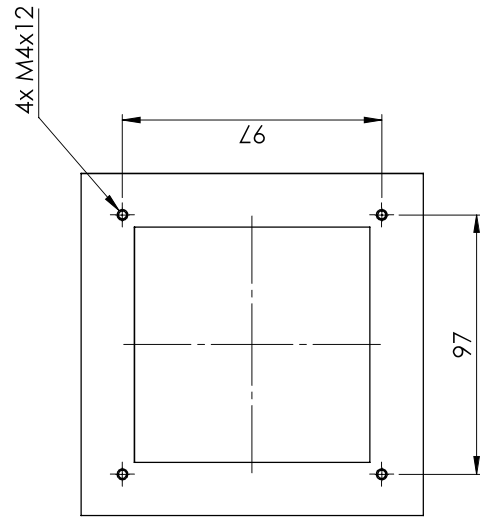
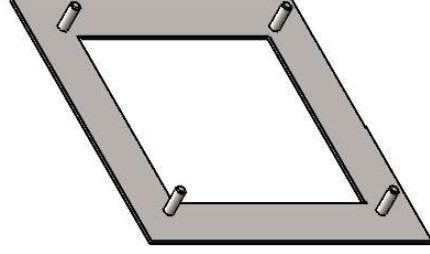

AIS4

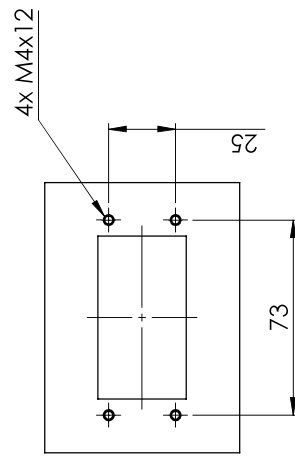
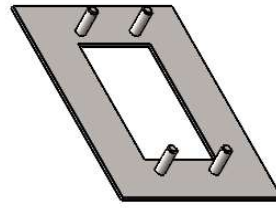

**STÜCKLISTE**  
**BILL OF MATERIALS**

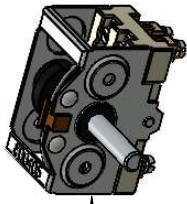

1

Hauptschalter 2 - polig  
2 pin main switch

Artikelnummer / Item Nr. : 800405

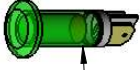

2

Anzeigelampe grün 230 V  
Indicator light green 230 V

Artikelnummer / Item Nr. : 800201



3

Sensor Tastenfeld Einbauvariante B  
Touch control panel version B

Artikelnummer / Item Nr. : 100176



4

Regler Hall Standard IO  
Controller Hall standard IO

Artikelnummer / Item Nr. : LP3 - 100108



5

Hall Potentiometer  
Hall potentiometer

Artikelnummer / Item Nr. : LP4 - 100108



6

1er Display 40 x 30 mm  
1 - digit display 40 x 30 mm

Artikelnummer / Item Nr. : AIS1



7

4er Display 58 x 30 mm  
4 - digit display 58 x 30 mm

Artikelnummer / Item Nr. : AIS4





8

Spin Control Hauptschalter  
Spin Control main switch

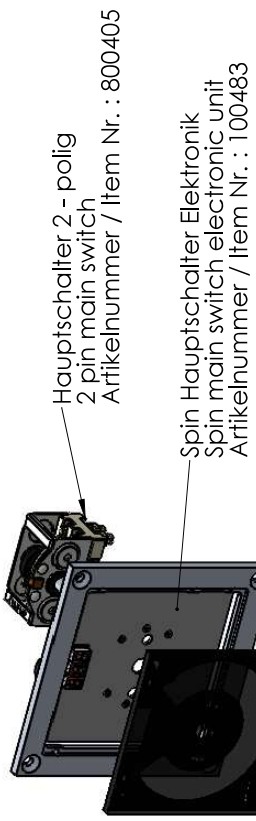

Hauptschalter 2 - polig  
2 pin main switch  
Artikelnummer / Item Nr. : 800405

Spin Hauptschalter Elektronik  
Spin main switch electronic unit  
Artikelnummer / Item Nr. : 100483

Glas / Glass  
Artikelnummer / Item Nr. : 900519



9.

Spin Control Regler  
Spin Control controller unit

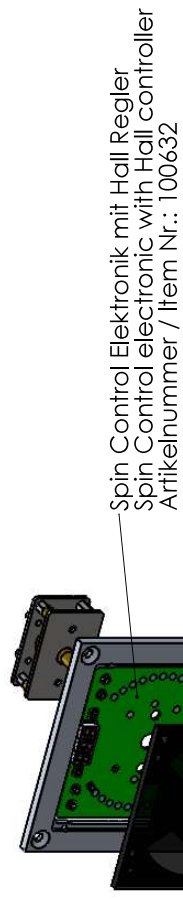

Spin Control Elektronik mit Hall Regler  
Spin Control electronic with Hall controller  
Artikelnummer / Item Nr.: 100632

Glas / Glass  
Artikelnummer / Item Nr. : 900519

**SCHALTKNEBEL**  
KNOB

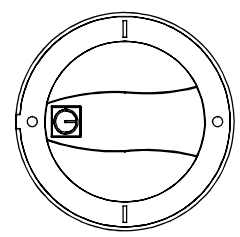

Hauptschalter 0-I-0-I  
Main switch 0-I-0-I

Art.nummer / Item Nr. : 800102

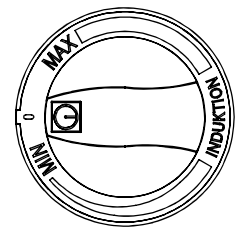

MIN - MAX Knebel für  
Induktion  
MIN - MAX knob for  
induction

Art.nummer / Item Nr. : 801019

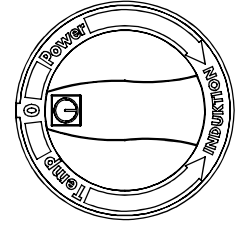

Temp / Power Knebel  
für Induktion  
Temp / Power knob  
for induction

Art.nummer / Item Nr. :

